



## Addendum # 1

---

For the Bid of  
Cedars Cold Storage- 2023  
FM12302  
22828 E. Canyon Rd.  
Cataldo, Idaho 83810  
5/22/2022

From: Miller Stauffer Architects  
601 E. Front Ave. Suite 201  
Coeur d'Alene, ID 83814  
Ph (208) 664-1773  
Fax (208) 667-3174  
Website: [www.millerstauffer.com](http://www.millerstauffer.com)

T.O. ALL PLAN HOLDERS

This Addendum consists of **02** pages of Addenda, plus **01** pages of revised or new construction drawings.

Important: Bidders must acknowledge receipt of this addendum as well as all other issued addenda on the forms provided with the Contract Documents, which must be utilized by bidder for bid to be considered responsive. Failure to do so may subject bidder to disqualification.

1. General
  - a. Prebid Sign In – No Attendants.
  - b. Minimum Design Criteria
    - i. Occupancy Risk Category: II
    - ii. Wind Design:
      1. Wind Speed, Ultimate Design Speed: 103
      2. Exposure Category: B
      3. Internal Pressure Coefficient: +/- 0.18
      4. Topographic Factor: 1.0
    - iii. Seismic Category: C
    - iv. Snow Load:
      1. Flat Roof Snow Load (PSF): 86
      2. Snow Drift Loading: None
      3. Snow Load Importance Factor: 1.0
      4. Ground Snow Load (PSF): 114

- 5. Snow Exposure Factor: B
  - 6. Thermal Factor 1.2
  - v. Design Soil Values:
    - 1. Allowable Foundation Bearing Pressure: 1500 psf
    - 2. Active Lateral Pressure (unrestrained): 45 psf/ft
    - 3. At-Rest Lateral Pressure (restrained): 60 psf/ft
    - 4. Coefficient of Sliding Friction: 0.45
  - vi. Air Freezing Index: 1500
  - vii. Weathering: Severe
  - viii. Frost Depth: 28"
2. Drawings
- a. Additions
    - i. None
  - b. Deletions
    - i. None
  - c. Revisions
    - i. A1.0 Site Plan
      - 1. Changed Finish Floor Elevation to 2273.25.
      - 2. Added Top of Wall (T.O.W.) and Top of Foundation (T.O.F.) Elevations. See attached A1.0 Site Plan.
  - d. Substitutions
    - i. None
3. Specifications
- a. Clarifications
    - i. Section 74619 Steel Siding and Roofing
      - 1. Approved equal manufacturers would include Metal Sales, Taylor Metal Products, PAC-CLAD and Miramac.
  - b. Additions
    - i. None
  - c. Deletions
    - i. None
  - d. Revisions
    - i. None
  - e. Substitutions
    - i. None

End of Addendum #1

SW 1/4

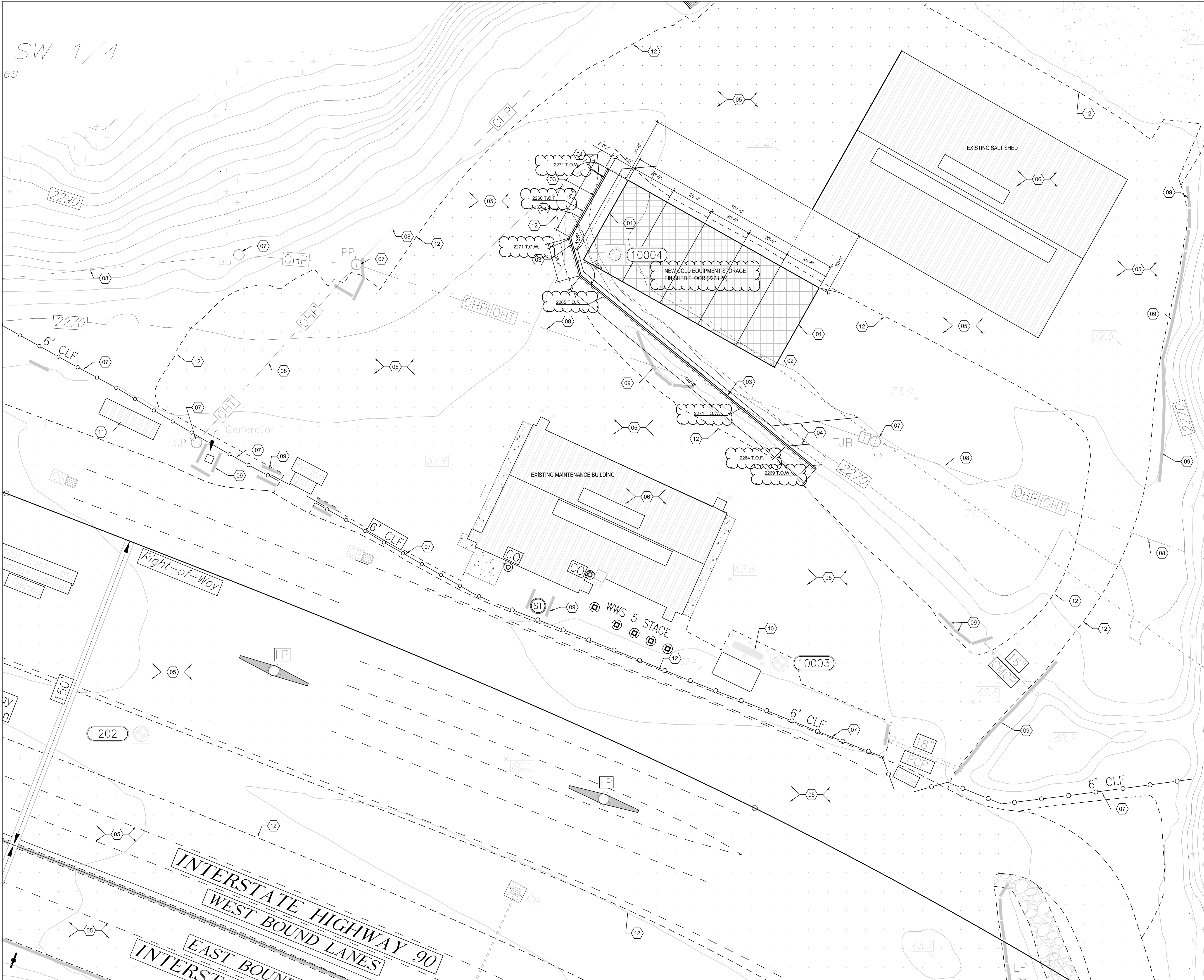

GENERAL NOTES

1.

xx GENERAL KEYNOTES

NOTE: ALL KEYNOTES MAY NOT BE USED IN DRAWINGS

- NEW COLD VEHICLE STORAGE POLE BUILDING
- NEW 100 AMP OVERHEAD POWER FEED WITH RAINHEAD MOUNTED ON BUILDING - METER TO BE INSTALLED ON INTERIOR SIDE OF WALL - DISTRIBUTION PANEL TO BE INSTALLED ON INTERIOR SIDE OF WALL
- NEW CAST-IN-PLACE CONCRETE RETAINING WALL - REFER TO DETAIL 1/A5.0
- NEW CONTOUR LINE
- EXISTING ASPHALT PAVEMENT TO REMAIN AS IS
- EXISTING BUILDING TO REMAIN AS IS
- EXISTING POWER POLE TO REMAIN
- OVERHEAD POWER LINE & TELECOMMUNICATIONS LINE
- CONCRETE JERSEY BARRIER
- EXISTING PROPANE TANK
- BOAT CHECK STATION FACILITY
- EDGE OF PAVEMENT

**MILLER STAUFFER**  
ARCHITECTS

601 E. Front Ave., Ste 201  
Burien, OR 97149  
P: 503-664-1718 F: 503-664-3974  
www.millerstauffer.com

Site Plan  
Bid / Permit Set  
05/02/2023

Cedars Cold Storage  
22825 E. Canyon Rd  
Cataldo, Idaho

LICENSED ARCHITECT  
ARC-60451

PROJECT NUMBER  
STATE OF IDAHO  
5-2-2023

REV.	DATE

PROJECT NO.: 2208  
DESIGNED BY: MPW  
DRAWN BY: MPW

**A1.0**

5/18/2023 10:48:55 AM  
s:\bid cedars cold storage\cds\sheet\1.0 site plan.dwg

**SITE PLAN**  
SCALE: 1" = 20'-0"